

MML2-HR110D / HR110

SCHOTT MORITEX Reference
Data do not guarantee the performance of the product

MML-High Resolution

Drawing No. A03129/A03454



レンズ形式	Lens Type	Fixed Magnification Object Side Telecentric Lens
光学倍率	Magnification	2.00
焦点距離 (mm)	Focal Length	43.30
有効Fno	Effective Fno	13.50
NA	Numerical Aperture	0.074
WD/OD (mm)	Working/Object Distance	110.0/113.0
O/I (mm)	Object to Image Distance	257.92
鏡筒長 (mm)	Mechanical Tube Length	130.40
レンズバック (mm)	Lens Back	81.82
被写界深度 (mm)	DOF @PCoC $\phi 0.04\text{mm}$	0.270
分解能 (μm)	Resolution @ $\lambda=550\text{nm}$	4.5
前側/後側主点位置 (mm)	Front/Rear Principal Position	-48.03/-48.18
入射/出射瞳位置 (mm)	Entrance/Exit Pupil Position	14,189,487.79/-4.86
入射/出射瞳径 (mm)	Entrance/Exit Pupil Diameter	2,073,272.96/6.33
テレセントリシティー (deg.)	Telecentricity	0.001(1/3Inch) 0.002(1/2Inch) 0.002(1/1.8Inch) 0.004(2/3Inch)
光学ディストーション (%)	Optical Distortion	-0.011(1/3Inch) -0.019(1/2Inch) -0.025(1/1.8Inch) -0.039(2/3Inch)
周辺光量比 (%)	Relative Illumination	99.77(1/3Inch) 99.58(1/2Inch) 99.47(1/1.8Inch) 99.22(2/3Inch)
質量 (g)	Weight	110.0/100.0
マウント	Mount	C Mount
イメージサークル径 (mm)	Image Circle	$\phi 11$
最大適合カメラ	Largest Compatible Camera	2/3 Inch

MML2-HR110D

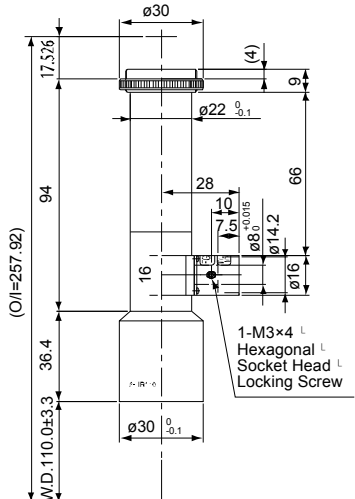

MML2-HR110

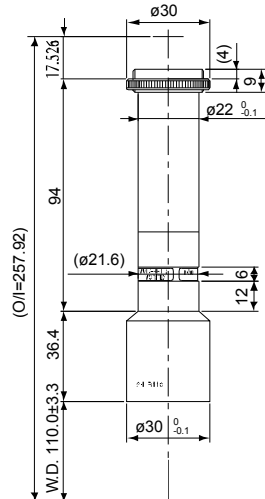

SCHOTT MORITEX Reference
Data do not guarantee the performance of the product

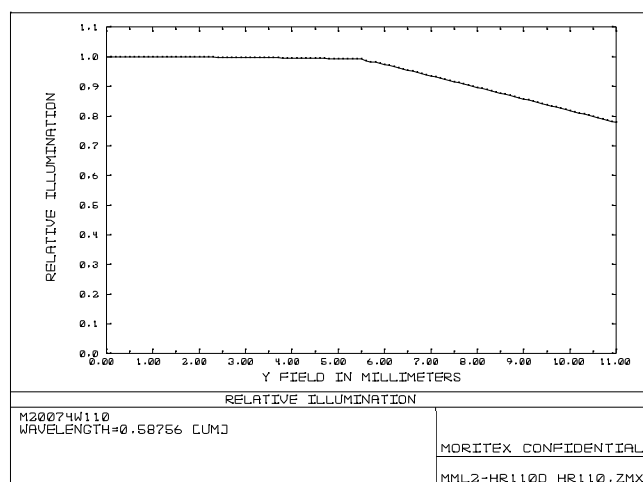
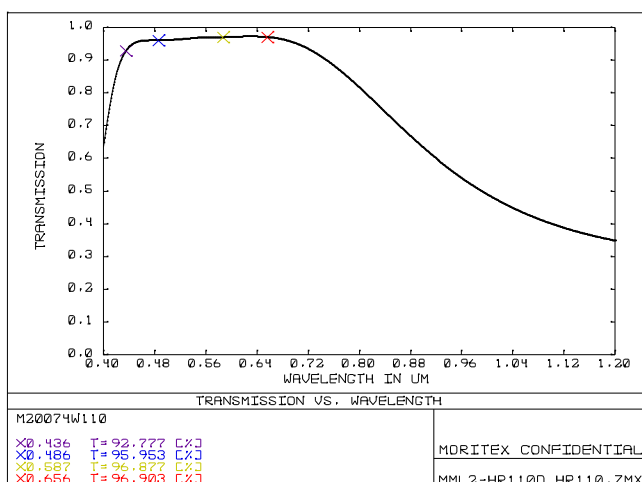
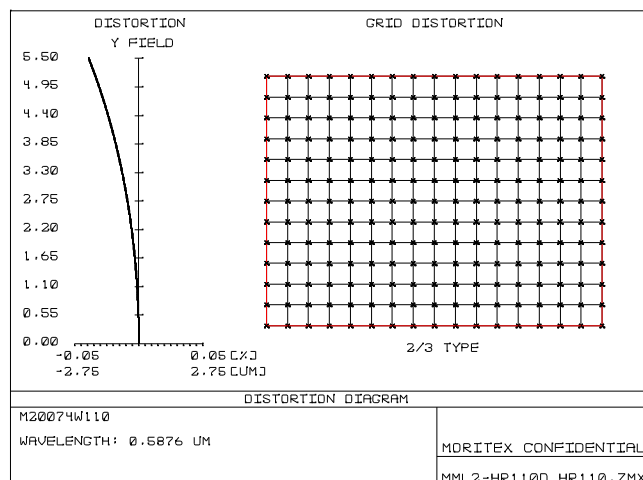
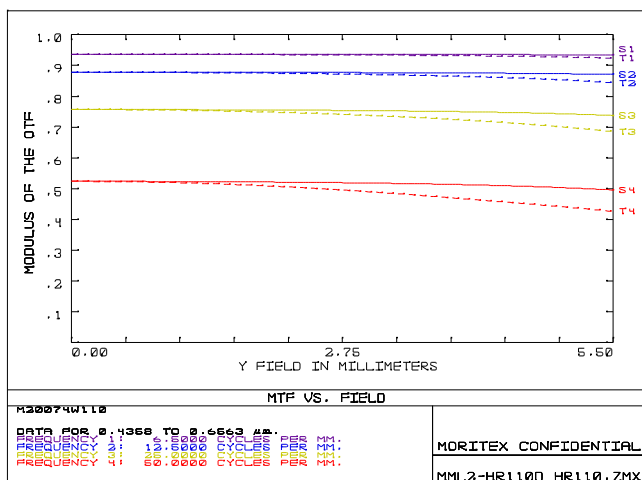

内容は、通知なしに随時変更されることがあります。

The content is subject to change at any time without notification.