

Rear Converter Lens ML-X

Attaching these lenses between a CCTV lens and a camera enables the adjustment of magnification without changing the working distance of the system.



*May decrease the resolution.

Configuration

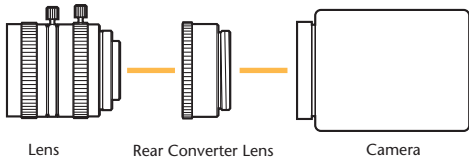

ML-1.5X

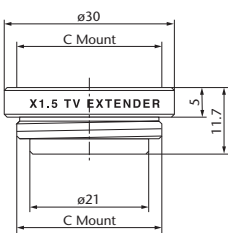

ML-2X

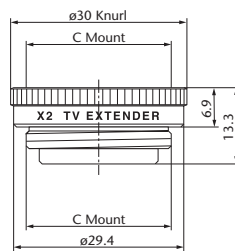

ML-2.5X

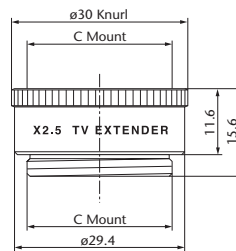

ML-3X

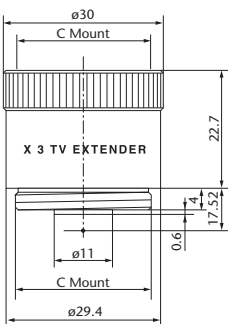

ML-4X

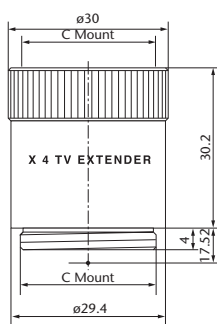

90° Mirror Prism ML-MLC

This prism adapter functions similar to the accessories provided for our telecentric lenses, allowing to bend the optical axis at a right angle.

- Fully supports CCTV M25.5, 27, and 30.5
- Equipped with screws to attach filters



90° Mirror Prism

ML-MLC

ML-MLC

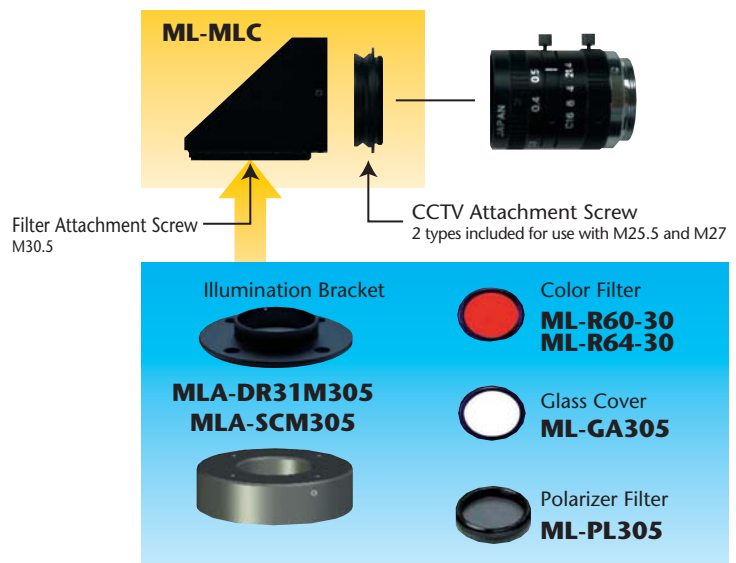
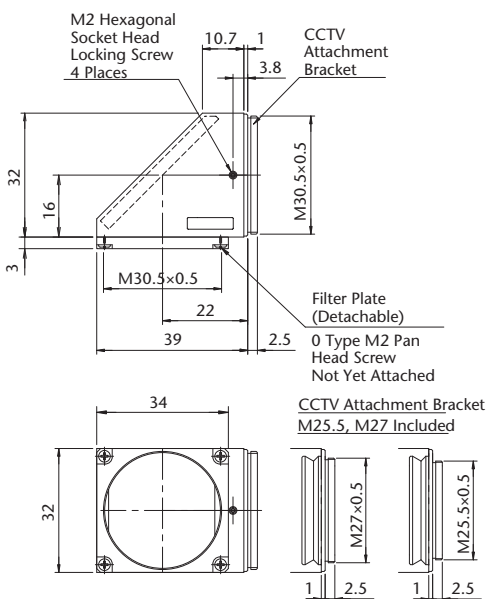

Accessories for CCTV Lenses

Glass Covers

ML-GA Series



A glass cover adapter for preventing the adhesion of dirt and foreign objects to the lens surface.

Polarizer Filters

ML-PL Series



Enhanced polarizing effect can be expected by using ML-PL Series second polarizer on lens side, in combination with MPL Series polarizer.

Accessories

Screw Pitch	M25.5 P0.5 Model	M27 P0.5 Model	M30.5 P0.5 Model
Glass Covers	ML-GA255	ML-GA270	ML-GA305
Polarizer Filter	ML-PL255	ML-PL270	ML-PL305
Polarizer Filter (With Locking Screw)	ML-PL255LB	ML-PL270LB	ML-PL305LB
Sharp Cut Filter		ML-R64-27	
Close-Up Ring		ML-EXR	

Close-Up Ring

ML-EXR Series

Used when using the CCTV lens at a close distance or when enlarging the magnification.

See comparison table on page P.73 for the field of view, working distance, and magnification when close-up ring is attached.

Model	Remarks
ML-EXR	Set of 7 (0.5, 1, 2, 5, 10, 20, 40)
ML-EXR05	0.5mm
ML-EXR1	1mm
ML-EXR2	2mm
ML-EXR5	5mm
ML-EXR10	10mm
ML-EXR15	15mm
ML-EXR20	20mm
ML-EXR25	25mm
ML-EXR30	30mm
ML-EXR40	40mm
ML-EXR50	50mm

